

HOUSING SIZE	SHAFT DIAMETER	PLUMMER BLOCK HOUSING	PLUMMER BLOCK HOUSING DIMENSIONS (mm)										
	d (mm)		D (H8)	B	b	G	F (H13)	A (h13)	L	H	E	d_1 (H12)	d_2 (H13)
SN 606	25	SN 606	72	185	52	22	37	50	82	95	150	26.5	38
SN 607	30	SN 607	80	205	60	25	41	60	90	110	170	31.5	43
SN 608	35	SN 608	90	205	60	25	43	60	95	115	170	36.5	48
SN 609	40	SN 609	100	255	70	28	46	70	105	130	210	41.5	53
SN 610	45	SN 610	110	255	70	30	50	70	115	135	210	46.5	58
SN 611	50	SN 611	120	275	80	30	53	80	120	150	230	51.5	67
SN 612	55	SN 612	130	280	80	30	56	80	125	155	230	56.5	72
SN 613	60	SN 613	140	315	90	32	58	95	130	175	260	62.0	77
SN 615	65	SN 615	160	345	100	35	65	100	140	195	290	67.0	82
SN 616	70	SN 616	170	345	100	35	68	112	145	215	290	72.0	89
SN 617	75	SN 617	180	380	110	40	70	112	155	218	320	77.0	94
SN 618	80	SN 618	190	400	110	33	74	112	160	230	320	82.0	99
SN 619	85	SN 619	200	420	120	36	77	125	170	245	350	87.0	104
SN 620	90	SN 620	215	420	120	38	83	140	175	280	350	92.0	111

Remark: All SN housings available with Felt-seals (FS).

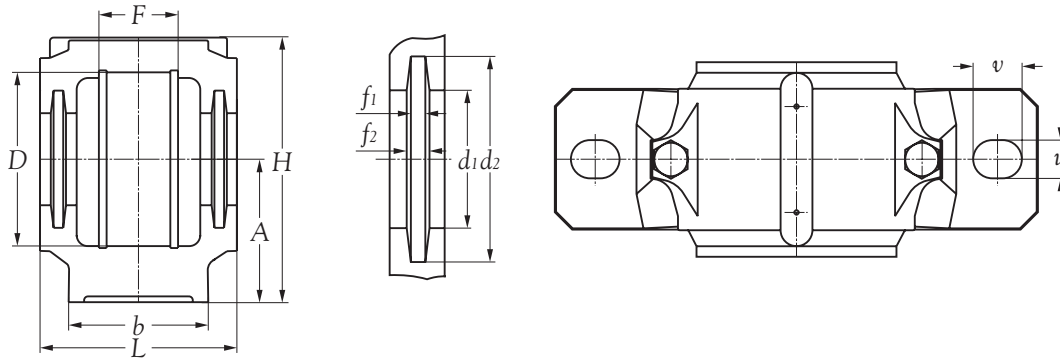

PLUMMER BLOCK HOUSING DIMENSIONS (mm)							APPROPRIATE APARTMENT					
f_1	f_2	u	v	s	t	WEIGHT Kg	BEARING NUMBER	ADAPTER SLEEVE	LOCATING RING		FELT SEAL	END COVER
									NUMBER	QTY		
4	5.4	15	20	M 12	M 10	2.2	1306 K	H 306	SR 72X9	2	FS 6X6X105	506 NA
							2306 K	H 2306	SR 72X10	1		
4	5.4	15	20	M 12	M 10	3.4	1307 K	H 307	SR 80X10	2	FS 6X6X120	507 NA
							2307 K	H 2307	SR 80X10	1		
4	5.4	15	20	M 12	M 12	3.4	1308 K	H 308	SR 90X10	2	FS 6X6X135	508 NA
							2308 K	H 2308	SR 90X10	1		
4	5.4	18	23	M 16	M 12	5.0	1309 K	H 309	SR 100X10.5	2	FS 6X6X150	509 NA
							2309 K	H 2309	SR 100X10	1		
4	5.4	18	23	M 16	M 12	5.4	1310 K	H 310	SR 110X11.5	2	FS 6X6X165	510 NA
							2310 K	H 2310	SR 110X10	1		
5	6.9	18	23	M 16	M 12	6.8	1311 K	H 311	SR 120X12	2	FS 6X9X190	511 NA-510 UA
							2311 K	H 2311	SR 120X10	1		
5	6.9	18	23	M 16	M 12	7.1	1312 K	H 312	SR 130X12.5	2	FS 6X9X205	512 NA-511 UA
							2312 K	H 2312	SR 130X10	1		
5	6.8	22	27	M 20	M 16	10.0	1313 K	H 313	SR 140X12.5	2	FS 6X9X220	513 NA-512 UA
							2313 K	H 2313	SR 140X10	1		
5	6.8	22	27	M 20	M 16	13.8	1315 K	H 315	SR 160X14	2	FS 6X9X235	515 NA-513 UA
							2315 K	H 2315	SR 160X10	1		
6	8.1	22	27	M 20	M 16	16.9	1316 K	H 316	SR 170X14.5	2	FS 8X10X255	516 NA
							2316 K	H 2316	SR 170X10	1		
6	8.1	26	32	M 24	M 20	18.9	1317 K	H 317	SR 180X14.5	2	FS 8X10X270	517 NA-515 UA
							2317 K	H 2317	SR 180X10	1		
6	8.1	26	35	M 24	M 20	19.8	1318 K	H 318	SR 190X15.5	2	FS 8X10X285	518 NA-516 UA
							2318 K	H 2318	SR 190X10	1		
6	8.1	26	35	M 24	M 20	24.7	1319 K	H 319	SR 200X16	2	FS 8X10X300	519 NA-517 UA
							2319 K	H 2319	SR 200X10	1		
7	9.3	26	35	M 24	M 20	27.0	1320 K	H 320	SR 215X18	2	FS 9X10X320	520 NA-518 UA
							2320 K	H 2320	SR 215X10	1		

Remark: All SN housings available with Felt-seals (FS).